

Ten Golden Rules for Correct Saniflo Installation



1 All horizontal pipes should have a minimum fall of 1:100. Discharge pipework should be copper or rigid solvent weld plastic, not 'pushfit'



2 If a vertical run is needed, this should be at the start of the run (within 30cm of the unit) and from the high point there must be a minimum fall of 1:100 (see rule 1).

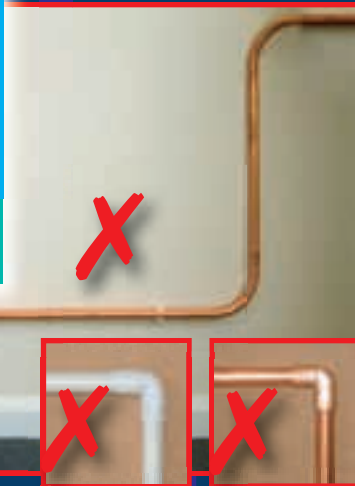

Bends should be smooth/long radius, not tight elbows. (Examples of copper and plastic shown.)

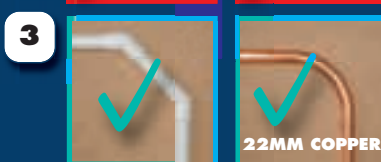

4 Pipes entering the Saniflo should have a gravity fall of 1:33.

Where the pipework falls to a floor lower for example, fit an air admittance valve at the highest point capable of withstanding 10psi pressure, or increase pipe size coming down to 'break' syphon.

5



6 Each Saniflo discharge pipe should run separately to the soil pipe. If wastes are combined, it can only be into a larger pipe, which is on a gravity fall.



7 The unit should be easily accessible and removable in the event of maintenance being required.



If boxed in, the boxing should be easily removed. Any extension between the WC pan spigot and wall should not exceed 150mm.



8 Since many close coupled WC suites do not have the space between the WC pan spigot and the wall, you may have to batten the cistern off the wall to make room for the Saniflo. However Sanislim will fit behind most closed coupled WC suites without the need for this.



9 Position the Saniflo behind the toilet not underneath it.



10 Electrical connection should be via an unswitched fixed wiring connector with a 5 amp fuse.

check out the website for details: www.saniflo.co.uk

SANIFLO

Saniflo Ltd. Howard House, The Runway, South Ruislip, Middx. HA4 6SE
Tel: 020 8842 0033 Fax: 020 8842 1671 e-mail: sales@saniflo.co.uk

